

Slat Top Stainless Steel Chain

Series **uni 8811 PLUS+** Type **Magnetic**

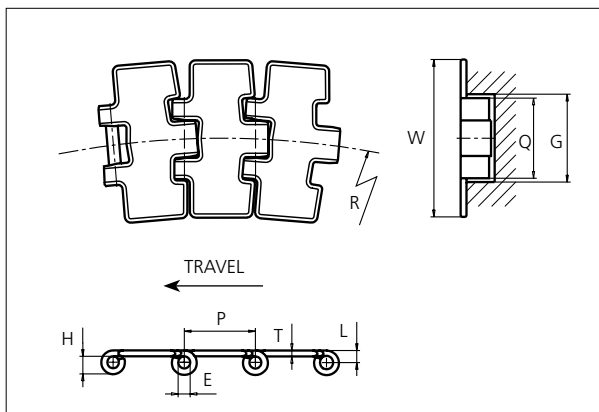

Slat Top Stainless Steel Chain

Side flexing chain
Pitch: 38.1 mm (1.50 in)
Backflex radius:
76.2 mm (3.00 in)

Standard shipping lengths:
coils of 80 links
= 3.048 m (10.0 ft)

| E | | G | | H | | L | | P | | Q | | T | |
|-----|------|------|------|-----|------|-----|------|------|------|------|------|-----|------|
| mm | in | mm | in | mm | in | mm | in | mm | in | mm | in | mm | in |
| 6.4 | 0.25 | 44.0 | 1.73 | 9.9 | 0.39 | 6.5 | 0.26 | 38.1 | 1.50 | 42.2 | 1.66 | 3.0 | 0.12 |

| | Width (W) | | Min. radius (R) | | Weight | | Permissible tensile strength N/lbf | Chain material | Pin material* | Surface | |
|-------------|-----------|------|-----------------|-------|--------|-------|------------------------------------|---|--|-----------|----------|
| | mm | in | mm | in | kg/m | lb/ft | | | | Roughness | Hardness |
| K325 | 82.6 | 3.25 | 500 | 19.69 | 2.50 | 1.68 | 3000 / 674 | S420 35 (Special Work hardened Crome-nickel ferritic Stainless Steel) | AISI 431 (Work hardened magnetic Stainless Steel) | < 0.3 µm | 30 HRC |
| K330 | 83.8 | 3.30 | | | 2.65 | 1.78 | | | | | |

* Chains with special hardened pin (HP) for additional wear resistance and higher corrosion strength are made to order.

STANDARD

SIDE FLEXING

PITCH 38.1 MM/1.50 IN

Any questions? Please contact us.

Morskate Aandrijvingen BV

Oosterveldsingel 47A
7558 PJ Hengelo (Ov)
The Netherlands

NL

T +31 (0)74 - 760 11 11
info@morskateaandrijvingen.nl
www.morskateaandrijvingen.nl

DE

T +49 692 - 222 34 95
info@morskateantriebstechnik.de
www.morskateantriebstechnik.de

EN

T +31 (0)74 - 760 11 11
info@morskatedrivetechnology.com
www.morskatedrivetechnology.com

Slat Top Stainless Steel Chain

Series **uni 8811 PLUS+** Type **Magnetic**

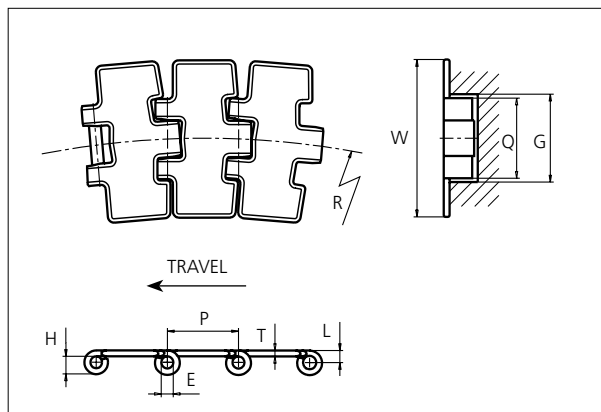

Slat Top Stainless Steel Chain

Side flexing chain
Pitch: 38.1 mm (1.50 in)
Backflex radius:
76.2 mm (3.00 in)

Standard shipping lengths:
coils of 80 in
= 3.048 m (10.0 ft)

| E | | G | | H | | L | | P | | Q | | T | |
|-----|------|------|------|-----|------|-----|------|------|------|------|------|-----|------|
| mm | in | mm | in | mm | in | mm | in | mm | in | mm | in | mm | in |
| 6.4 | 0.25 | 44.0 | 1.73 | 9.9 | 0.39 | 6.5 | 0.26 | 38.1 | 1.50 | 42.2 | 1.66 | 3.0 | 0.12 |

| | Width (W) | | Min. radius (R) | | Weight | | Permissible tensile strength N/lbf | Chain material | Pin material* | Surface | |
|-------------|-----------|------|-----------------|-------|--------|-------|------------------------------------|---|--|-----------|----------|
| | mm | in | mm | in | kg/m | lb/ft | | | | Roughness | Hardness |
| K450 | 114.3 | 4.50 | 500 | 19.69 | 3.20 | 2.15 | 3000 / 674 | S420 35 (Special Work hardened Crome-nickel ferritic Stainless Steel) | AISI 431 (Work hardened magnetic Stainless Steel) | < 0.3 µm | 30 HRC |
| K750 | 190.5 | 7.50 | | | 4.90 | 3.29 | | | | | |

* Chains with special hardened pin (HP) for additional wear resistance and higher corrosion strength are made to order.

NON STANDARD

SIDE FLEXING

PITCH 38.1 MM/1.50 IN

Any questions? Please contact us.

Morskate Aandrijvingen BV
Oosterveldsingel 47A
7558 PJ Hengelo (Ov)
The Netherlands

NL
T +31 (0)74 - 760 11 11
info@morskateaandrijvingen.nl
www.morskateaandrijvingen.nl

DE
T +49 692 - 222 34 95
info@morskateantriebstechnik.de
www.morskateantriebstechnik.de

EN
T +31 (0)74 - 760 11 11
info@morskatedrivetechnology.com
www.morskatedrivetechnology.com

Sprocket

| No of teeth | Pitch diameter | | Overall-diameter | | Min. ø bore | | Max. ø bore | | Hub-diameter | | Dimension A | | Dimension B | | Molded PA6 LG | Molded Cast Iron | Machined PA6  |
|-------------|----------------|------|------------------|------|-------------|------|-------------|------|--------------|------|-------------|------|-------------|------|---------------|------------------|--|
| | mm | in | mm | in | mm | in | mm | in | mm | in | mm | in | mm | in | | | |
| Z19 | 117.3 | 4.62 | 117.0 | 4.61 | 20.0 | 0.79 | 40.0 | 1.57 | 58.0 | 2.28 | 58.7 | 2.31 | 64.5 | 2.54 | ✓ | ✓ | |
| Z21 | 129.2 | 5.09 | 130.0 | 5.12 | 20.0 | 0.79 | 40.0 | 1.57 | 58.0 | 2.28 | 65.0 | 2.56 | 70.5 | 2.78 | ✓ | ✓ | |
| Z23 | 141.2 | 5.56 | 142.0 | 5.59 | 20.0 | 0.79 | 40.0 | 1.57 | 58.0 | 2.28 | 71.2 | 2.80 | 76.5 | 3.01 | ✓ | ✓ | |
| Z25 | 153.2 | 6.03 | 155.0 | 6.10 | 20.0 | 0.79 | 40.0 | 1.57 | 58.0 | 2.28 | 77.4 | 3.05 | 82.5 | 3.25 | ✓ | ✓ | |
| Z27 | 165.2 | 6.50 | 167.0 | 6.57 | 20.0 | 0.79 | 70.0 | 2.76 | n/a | n/a | 83.6 | 3.29 | 88.5 | 3.48 | | ✓ | ✓ |
| Z29 | 177.2 | 6.98 | 179.0 | 7.05 | 20.0 | 0.79 | 70.0 | 2.76 | n/a | n/a | 89.8 | 3.54 | 94.6 | 3.72 | | ✓ | ✓ |
| Z31 | 189.3 | 7.45 | 192.0 | 7.56 | 20.0 | 0.79 | 70.0 | 2.76 | n/a | n/a | 95.9 | 3.78 | 100.6 | 3.96 | | ✓ | ✓ |

Two part sprocket

| No of teeth | Pitch diameter | | Overall-diameter | | Min. ø bore | | Max. ø bore | | Hub-diameter | | Dimension A | | Dimension B | | Molded PA6 LG |
|-------------|----------------|------|------------------|------|-------------|------|-------------|------|--------------|------|-------------|------|-------------|------|---------------|
| | mm | in | mm | in | mm | in | mm | in | mm | in | mm | in | mm | in | |
| Z19 | 117.3 | 4.62 | 117.0 | 4.61 | 20.0 | 0.79 | 40.0 | 1.57 | 58.0 | 2.28 | 58.7 | 2.31 | 64.5 | 2.54 | ✓ |
| Z21 | 129.2 | 5.09 | 130.0 | 5.12 | 20.0 | 0.79 | 40.0 | 1.57 | 58.0 | 2.28 | 65.0 | 2.56 | 70.5 | 2.78 | ✓ |
| Z23 | 141.2 | 5.56 | 142.0 | 5.59 | 20.0 | 0.79 | 40.0 | 1.57 | 58.0 | 2.28 | 71.2 | 2.80 | 76.5 | 3.01 | ✓ |
| Z25 | 153.2 | 6.03 | 155.0 | 6.10 | 20.0 | 0.79 | 40.0 | 1.57 | 58.0 | 2.28 | 77.4 | 3.05 | 82.5 | 3.25 | ✓ |

Molded sprocket



Cast iron sprocket



Machined sprocket



Two part sprocket



Non standard material and color:
See uni Material and Color Overview.

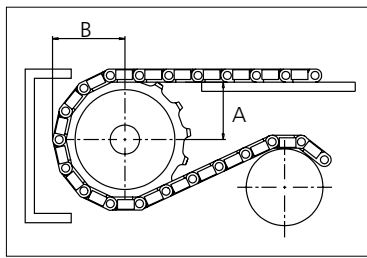

Please ensure that sufficient size shaft and keyway are chosen for corresponding load.

Other sprocket sizes are available upon request

Width of tooth: 31.8 mm/1.25 in

Width of sprocket: 42.3 mm/1.67 in

uni Retainer Rings: See uni Retainer Ring data sheet

uni Idler: See uni Idler data sheet

uni Guide Rings can be mounted on cast iron and machined sprockets. See uni Guide Rings data sheet

Any questions? Please contact us.

Morskate Aandrijvingen BV

Oosterveldsingel 47A
7558 PJ Hengelo (Ov)
The Netherlands

NL

T +31 (0)74 - 760 11 11
info@morskateaanrijvingen.nl
www.morskateaanrijvingen.nl

DE

T +49 692 - 222 34 95
info@morskateantriebstechnik.de
www.morskateantriebstechnik.de

EN

T +31 (0)74 - 760 11 11
info@morskatedrivetechnology.com
www.morskatedrivetechnology.com